

A two-story red brick house with white plastered sections. The ground floor features a central arched entrance with a dark wooden door and a small checkered tile path. To the left of the door is a white-framed bay window, and to the right is a larger white-framed bay window. The first floor has a white-framed bay window on the left and a larger white-framed bay window on the right. The roof is dark grey with a white gutter. A blue fence is visible on the left side of the house.

Castles

OFFERS IN EXCESS OF

**£274,950**

**Craig Park Road**

London, N18 2HQ



## PROPERTY SUMMARY

A two bedroom ground floor Maisonette situated within a mile of Silver Street and A406 road links. The property consists of two bedroom, Reception, kitchen and bathroom. It also has features to include, 923 year lease, no service charge, 58ft rear garden and is offered for sale on a chain free basis.







Craig Park Road, London, N18 Approximate Gross Internal Area = 623 sq ft / 57.9 sq m

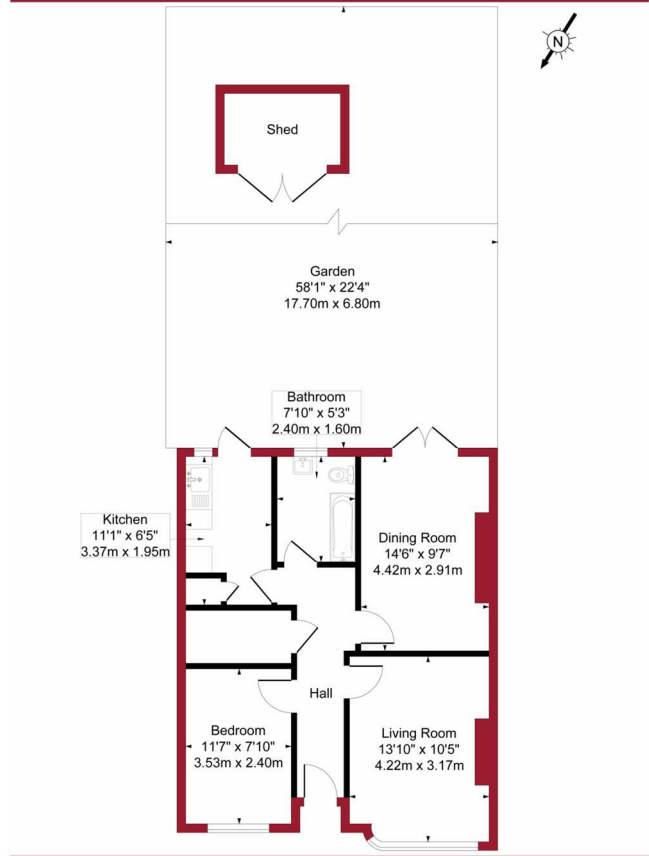

PINK PLAN

Floor plan produced in accordance with RICS Property Measurement 2nd Edition. Although Pink Plan Ltd ensures the highest level of accuracy, measurements of doors, windows and rooms are approximate and no responsibility is taken for error, omission or misstatement. These plans are for representation purposes only and no guarantee is given on the total square footage of the property within this plan. The figure icon is for initial guidance only and should not be relied on as a basis of valuation.

Castles

For a guide to the area please scan this code for more information

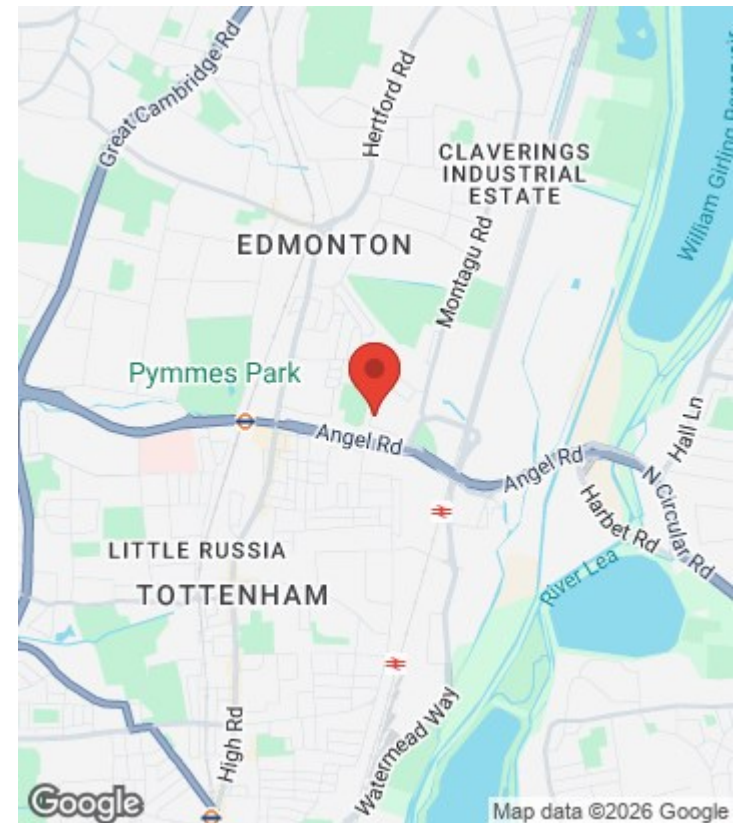
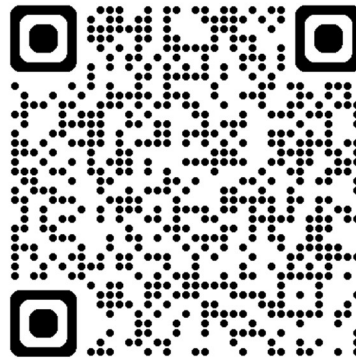

Maisonette - Garden

Leasehold

**Council:**

**Council Tax Band: B**

Agents Note: Whilst every care has been taken to prepare these particulars, they are for guidance purposes only. All measurements are approximate and are for general guidance purposes only and whilst every care has been taken to ensure their accuracy, they should not be relied upon and potential buyers/tenants are advised to recheck the measurements



## OFFICE ADDRESS

438 Hertford Road  
Edmonton  
London  
N9 8AB

## OFFICE DETAILS

020 8804 8123  
edmonton@castles.london  
<https://www.castles.london/>

